

# CERTIFIED SQUARE FOOTAGE REPORT

25716 SE 27TH STREET  
Sammamish, WA, 98075

## GROSS LIVING AREA (GLA)

- Floor 1 - 2534 sq ft
- Floor 2 - 2306 sq ft
- Total GLA - 4840 sq ft**

## CERTIFIED SQUARE FOOTAGE GLA

**4840 SQ FT**  
accurate to at least 99.5%

## GROSS INTERNAL AREA (GIA)

- Floor 1 - 2392 sq ft
- Floor 2 - 2150 sq ft
- Total GIA - 4542 sq ft**

## Other non-GLA Areas

Garage - 941 sq ft  
Covered Porch - 135 sq ft  
Open To Below - 396 sq ft

**GIA** = the interior living area measured to the internal face of the perimeter walls (paint to paint)

**GLA** = all above-grade living area (in green) including external walls using a standard 6.5 inch wall thickness

Floor 1



Floor 2

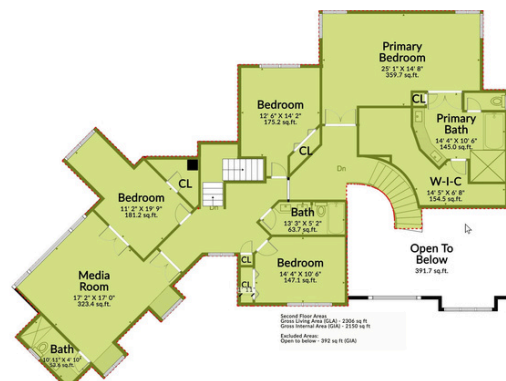



## FLOOR 1

- Gross Living Area - 2534 sq ft
- Gross Internal Area - 2392 sq ft

### Excluded GLA Areas:

**Garage - 944 sq ft**

**Covered Porch - 135 sq ft**

GLA = all areas in green include external walls using a 6.5 inch wall thickness unless otherwise noted. The GLA calculation was created pursuant to: Square Footage-Method for Calculating: ANSI® Z765-2021 (American National Standards Institute®) measuring standard for measuring, calculating, and reporting above and below grade square footage. Floor plan created using a 3D property scan via a Matterport Pro camera and HomeDiary's 3D floor plan system. Floor plan and square footage limited to areas scanned and drawn at the time of the property visit. See and learn more at [homed diary.com/pro/certified/](https://homed diary.com/pro/certified/)

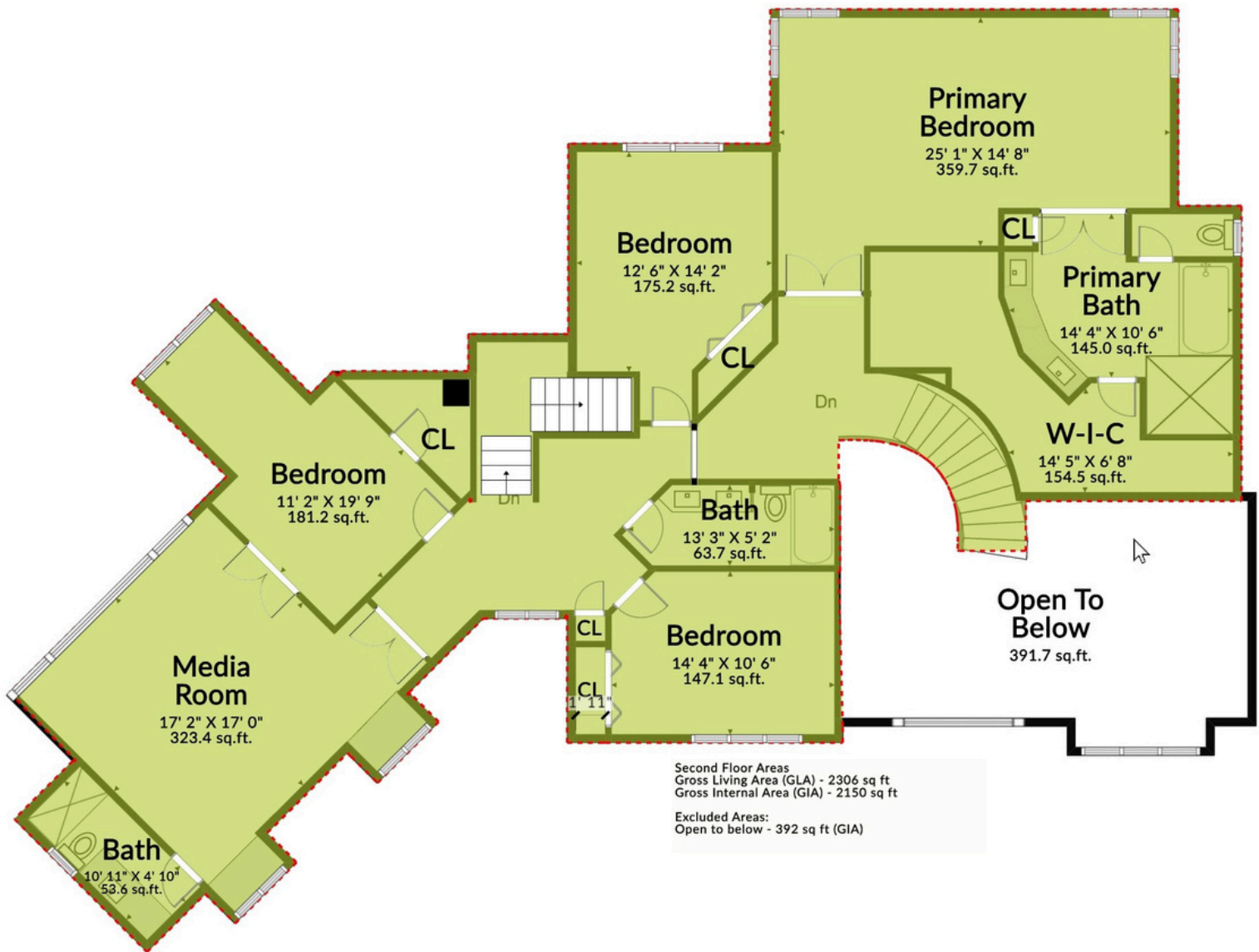

## FLOOR 2

- Gross Living Area - 2306 sq ft
- Gross Internal Area - 2150 sq ft

**Excluded GLA Areas:**  
**Open To Below - 392 sq ft**

GLA = all areas in green include external walls using a 6.5 inch wall thickness unless otherwise noted. The GLA calculation was created pursuant to: Square Footage-Method for Calculating: ANSI® Z765-2021 (American National Standards Institute®) measuring standard for measuring, calculating, and reporting above and below grade square footage. Floor plan created using a 3D property scan via a Matterport Pro camera and HomeDiary's 3D floor plan system. Floor plan and square footage limited to areas scanned and drawn at the time of the property visit. See and learn more at [homed diary.com/pro/certified/](https://homed diary.com/pro/certified/)